

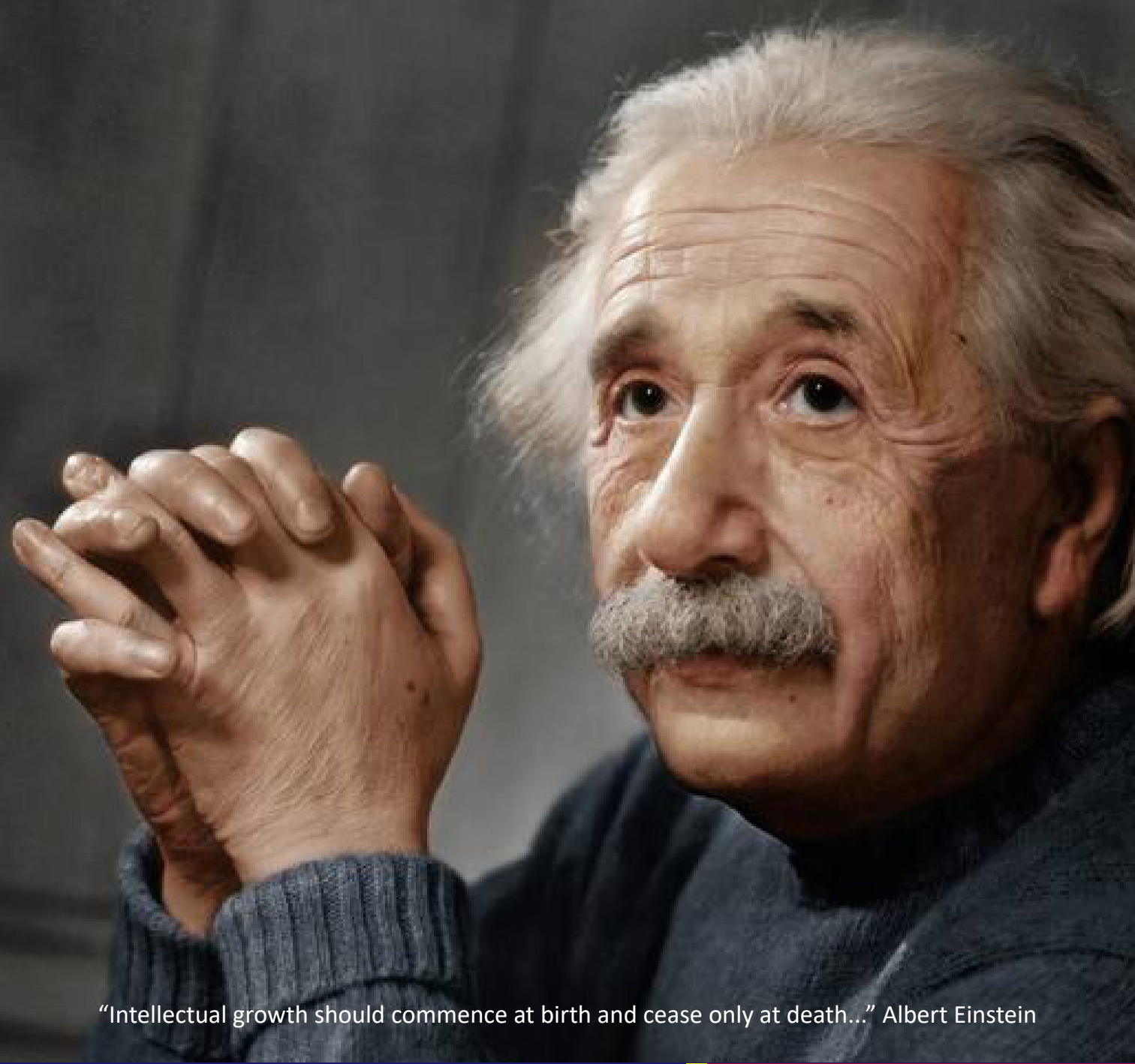

TIBET CAMPUS

Pathways to your future

THE INSTITUTE OF BUSINESS, ENGINEERING & TECHNOLOGY
PANADURA



“Intellectual growth should commence at birth and cease only at death...” Albert Einstein



“TIBET is committed to student success and providing excellence in education, skills development and entrepreneurship with our innovative approach to build leaders for our society and workplaces”.

TIBET is committed to student success and providing excellence in education, skills development and entrepreneurship with our innovative approach to build leaders for our society and workplaces. We provide a superior quality education backed with practical exposure where applicable and committed to build organizational capacity to support our philosophy and transform the lives of our students whilst becoming a model institution. We create a climate of innovation and continuous improvement as part of a high-performance organization.

The Institute of Business, Engineering and Technology (TIBET) will strive to provide a responsible teaching experience, meeting student and community educational and developmental needs and continuing a vision of leadership in post-secondary education in the area and beyond.

Current economic challenges and technological advances have created an increasingly complex post-secondary marketplace. Potential students, who range from recent school leavers, graduates to the newly unemployed and also the newly employed need clear information about their options and the various support available for commencing or developing a career.

Our Vision

“Be a premier in providing career education and professional training and transforming the lives of our students to meet future demands.”

Our Mission

“In collaboration with world leading International Educational Institutions and Universities, develop knowledge, skills, abilities, entrepreneurship to create educated and dynamic individuals to become leaders in society and workplaces whilst improving the lives of our employees thus contributing to the development of the nation”.





Our Values

We believe in the following values that guide our daily work as we strive to realize our vision and achieve our mission.

Quality - we are committed to the highest standards of excellence.

Learning – we are learner focused and act to enhance the learning experience

Responsiveness – we monitor the local and global marketplace and respond quickly embracing innovation and creative thinking

Teamwork – We communicate effectively and work collaboratively to achieve shared goals. We consider other's ideas, feedback and change and establish strong partnerships.

Inclusion - We embrace the principles of fairness and equity in everything we do and treat each other with respect. We have created and worked in a highly professional and receptive environment.

A hand is shown from the wrist up, making a peace sign (V-sign) with the index and middle fingers. The hand is wearing a gold ring on the ring finger and a blue cloth is wrapped around the wrist. The background is a solid blue color.

Make it happen

The Vision of the institution commits to student success and providing excellence in education, skills development and entrepreneurship with our innovative approach to build leaders for our society and workplaces.



Our Resources

The Academic studies are headed by a panel of Senior Academics well recognized and respected in their fields and well experienced lecturers. They will provide the required advises and guidelines for the academic studies and will also supervise the lecturers to ensure that quality subject matter is delivered. The students too will get the opportunity to discuss any academic problems or to obtain any required guidance from them.



Our Goals

Students will be the central focus of our Mission and Vision. Thus, two overarching goals serve as the foundation of all we do.

Superior quality education experience. Student engagement and success are the most important results that we will deliver. These outcomes are unequivocal. We achieve them through expert faculty and staff, relevant curricula, valued credentials, opportunities for lifelong learning experiences, personal development, informed course and program choices, varied delivery options, and appropriate supports and services that are timely and targeted to individual student needs.

With development we plan to provide lifelong access opportunities to higher education and training. Our plans to this end include a diversity of academic opportunities, partnership agreements with universities, boards of education, community groups and industry associations; supports and services that promote access, retention and student success; In order to achieve the expected results from these two goals, we pursue a strategic direction that differentiates our institute in a meaningful way, adding value for our students and alumni, their employers, our employees, the communities we serve and, ultimately, society as a whole.



Our Priorities

Our strategic direction is further defined by the following priorities, which guide our work and support our commitment to superior quality education experience and access to success:

Build, develop and transform our institute as a model of higher education.

Build organizational capacity to support our philosophy
Create and develop a climate for innovation and continuous improvement as a high performing institute.

“The roots of education are bitter, but the fruit is sweet...” Aristotle

Registrations and Accreditations



Pearson U.K.



Ed hat International, U.K. Tertiary & Vocational Education
Commission of Sri Lanka



BTEC U.K.



OTHM U.K.

What we offer:

Engineering & Technology School

Pearson BTEC Level 4 Higher National Certificate in Construction and the Built Environment (Civil Engineering)
Pearson BTEC Level 4 Higher National Certificate in Construction and The Built Environment (Surveying)
Pearson BTEC Level 4 Higher National Certificate in Quantity Surveying

Pearson BTEC Level 5 Higher National Diploma in Construction and the Built Environment (Civil Engineering)

Pearson BTEC Level 5 Higher National Diploma in Construction and The Built Environment (Surveying)

Pearson BTEC Level 5 Higher National Diploma in Quantity Surveying

- Specialization in Engineering / Engineering Surveying / Building Surveying
- Specialization in Quantity Surveying
- Construction Management

Quantity Surveying TVEC NVQ Level 4, 5 and 6

AutoCAD
Revit
CostX
MS Project
Primavera
SAP 2000
SolidWorks

Business School

OTHM Qualifications
Diploma Level 4 & 5 Business Management
Diploma Level 4 & 5 Logistics & Supply Chain Management

Language School

English Language
General English for Adults
English for Corporates & Business
IELTS
Pearson Test of English
Elocution for school children

Corporate training

Seminars & Workshops for Continued Professional Development

Computing School

Diploma Level 4 & 5 Information Technology (OTHM Qualification)
Graphic Design, Photoshop, InDesign, Illustrator, Aftereffects
3DS Max
E Kids & Teens
ICT for school children
MS Office 2016





Engineering & Technology School

Courses related to the Construction and Engineering industry and associated software training.



Pearson BTEC HND Construction and the Built Environment (Civil Engineering)

This is a Higher National Diploma programme which focuses on the design, construction and maintenance of artificially and naturally built environments. It has many carrier sub-disciplines such as structural engineering, geo-technical engineering, water resource engineering, environmental engineering, construction engineering, coastal engineering, material science and engineering, transportation engineering, earthquake engineering and project management. This program provides educational, research, industrial and professional experience to learners in order to build leading careers in the Civil Engineering industry.

This programme is ideally suited for those looking forward to an Engineering profession and furthering academic studies to higher levels.

Students can earn an internationally recognized Pearson (Edexcel UK) qualification after completing this program. The course contains 19 learning modules, a design project and an internship in a civil engineering organization. Student friendly academic staff is available to provide extra support to the students.

After completion of Pearson BTEC HND in Construction and the Built Environment (Civil Engineering) programme, students will be able to:

- Enter new employment in the civil engineering field
- Advancing one's career
- Qualify to enroll for the final year of a higher qualification such as BEng (Hons) in Civil and Infrastructure Engineering degree programmes.

The units are designed to meet the skill needs of the civil engineering sector cover the full range of employment within the sector.



Pearson BTEC HND Construction and the Built Environment (Surveying)

This programme is a Higher National (U.K. Level 4 and 5) and designed for students who wish to pursue or advance their career in the Construction industry. The qualification is a Higher National Diploma in Construction and the Built Environment (Surveying) delivered through Pearson Edexcel of U.K. and successful students can either find employment in the construction industry or progress to a top up degree in Civil Engineering, Quantity Surveying, Engineering Surveying or Construction Management. The program of study comprises of two segments – Level 4 and Level 5, both spanning over a period of two years – four semesters.

The purpose of BTEC Higher Nationals in Construction and The Built Environment (Surveying) programme is to develop students as professionals with the ability to meet the demands of employers in the industry sector and adapt to a constantly changing and competitive world. The qualification will provide progression to higher education and enhance the career prospects.

On successful completion of the program the student will be able to:

- Enter new employment
- Advancing in the employment
- Progressing to a higher qualification such as a degree

The course will be delivered in accordance with Sri Lanka industry standards/ requirements.

The units are designed to meet the skill needs of the sector and the specialist units allow coverage of the full range of employment within the sector.



Pearson HND Quantity Surveying

This programme is a Higher National (U.K. Level 4 and 5) and designed for students who wish to pursue or advance their career in Quantity Surveying. The qualification is a Higher National Diploma in Quantity Surveying delivered through Pearson Education of U.K. and successful students can either find employment in the construction industry or progress to a top up degree in Quantity Surveying or Construction Management. The program of study comprises two segments – Level 4 and Level 5 both spanning over a period of two years – four semesters.

The purpose of the HND in Quantity Surveying is to develop learners as specialised Quantity Surveyors with the ability to meet the demands of the employers in the industry sector and adapt to a constantly changing and competitive world where the norm is Value for Money and 'on time' delivery. The qualification will provide progression to higher education and enhance the career prospects.

The units are designed to meet the skill needs of the sector and the specialist units allow coverage of the full range of employment within the sector.

On successful completion the learner will be able to:

- Enter new employment
- Advance in the current employment
- Progress to a higher qualification such as a degree

The Course will be delivered in accordance with Sri Lanka industry standards/requirements.

Quantity Surveying

TVEC

This program is NVQ level 4, 5 and 6 and delivered in accordance with the guidelines of the Tertiary and Vocational Education Commission (TVEC) of Sri Lanka. Level 4 is the Certificate level whilst level 5 and 6 are Diploma and Higher National Diploma levels. Level 4 is a 6 months programme and levels 5 and 6 combined is for a period of two years. The Total Qualification Time for Level 5 and 6 combined is 960 Hours and include all forms of supervised learning.

The purpose of this programme is to develop students as professional Quantity Surveyors and instill knowledge and skills as per the industry requirements.

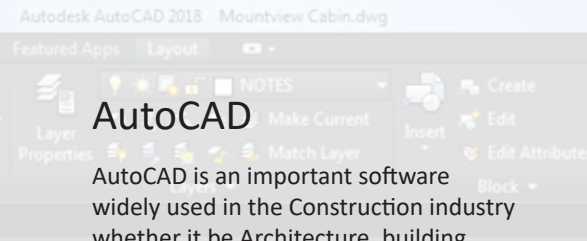
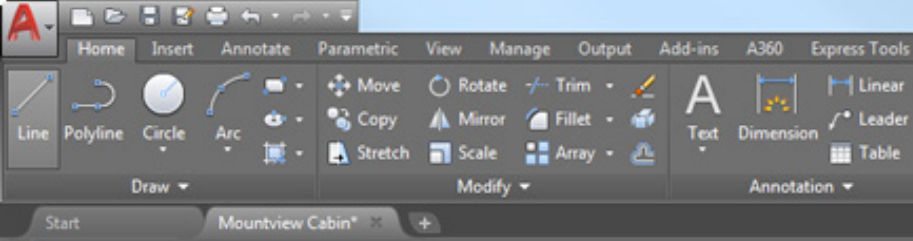

AutoCAD

AutoCAD is an important software widely used in the Construction industry whether it be Architecture, building & construction, surveying, facility management or project management.

FLAG NOTES

- ① 12"-14" BEAM DIAMETER LOGS WITH FULL SCRIBE APPROX. 9'-0" HEIGHT.
- ② FIREPLAC: INSERT WITH COMPLY WITH MANUFACTURER'S REQUIREMENTS.
- ③ LOG STAIR SYSTEM: 10" ASSUMIN: 8'-0" LOG WALL TAG PLYWOOD DECKING.
- ④ 60"x60" JACUZZI TUB.
- ⑤ 36"x36" SHOWER w/ TEMPERATURE CONTROL.
- ⑥ DOUBLE VANITY.
- ⑦ UPPER LEVEL LOG BEAMS ABOVE, TYP.
- ⑧ 5-1/2"x10" LOG COLUMN PROVIDE ACCESS AS REQ.
- ⑨ LOG RAILING, TYP.
- ⑩ LOG DECK RAILING, OPTIO.
- ⑪ CRAWLSPACE ACCESS IN EQUIPMENT REFER TO ME CONTRACTOR.
- ⑫ 8'-0" HIGH CLOSET WITH.
- ⑬ LOG STAIRS DOWN TO MAIN LEVEL, TYP.
- ⑭ LOG ROCK MEMBERS ABOVE, TYP.
- ⑮ LOG RAILING, TYP.

AutoCAD has changed the way the world works, mainly in the engineering and architectural industries. It has replaced traditional drafting and design methods like pen and paper, allowing industries to plan, simulate and produce their new ideas in a single program.

This is a high performing tool used by Professionals across the industry to design and visualize their ideas, to quantify and measure, speed documentation and improve accuracy and efficiency.

A sound knowledge of this software will increase individual and organizational productivity and is a must for all construction professionals as well as those aspiring to be construction industry professionals.

This course is ideal for:

- Newcomers to AutoCAD and CAD drawing.
- Users with little AutoCAD experience.
- Users who have previously used a different CAD tool and wish to switch to AutoCAD, students who wish to pursue a career in draftsman, quantity surveying, construction industry, engineering industry.

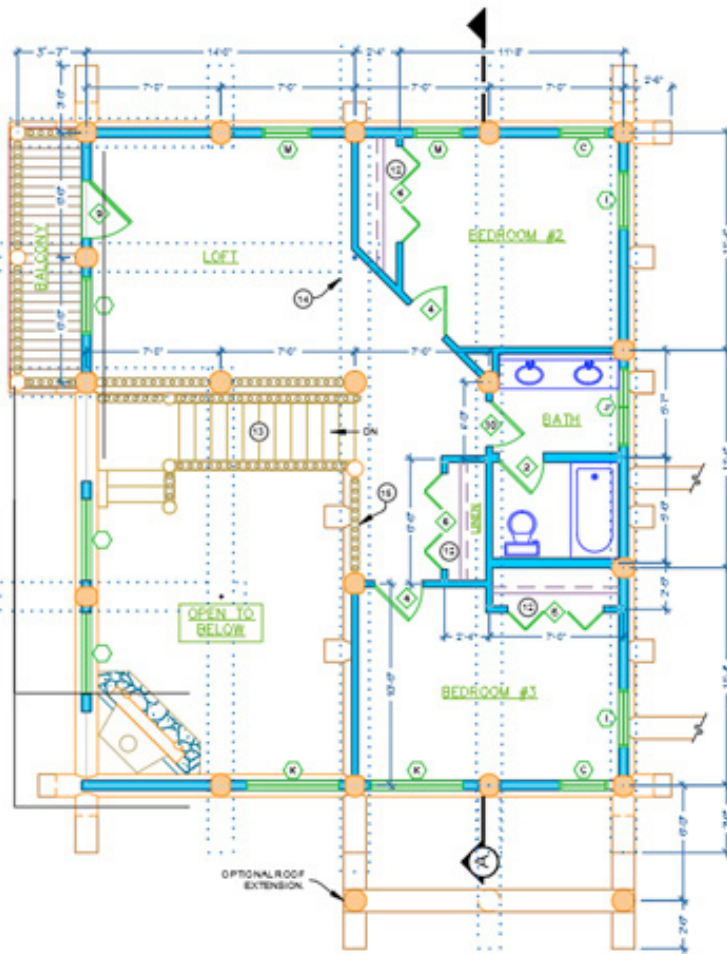

UPPER FLOOR PLAN
1/4" = 1'-0"

SQ FOOTAGE SUMMARY	
MAIN FLOOR	1,200
SECOND FLOOR	1,200
DECK/PATIO	1,200

Revit

Revit software is specifically made for Building Information Modeling (BIM), empowering design and construction professionals to bring ideas from concept to construction with a coordinated and consistent model-based approach. It includes the functionality of all of the Revit disciplines (architecture, MEP, and structure) in one unified interface. The Autodesk Revit software is a powerful Building Information Modeling (BIM) program that works the way architects think and is a software widely used in the Construction industry whether it be Architecture, Building & Construction, Surveying, Facility Management or Project Management. The program streamlines the design process through the use of a central 3D model, where changes made in one view update across all views and on the printable sheets.

Revit has changed the way the world works, mainly in the engineering and architectural industries. It has replaced traditional drafting and design methods like pen and paper, allowing industries to plan, simulate and produce their new ideas in a single program.

This is a high performing tool used by Professionals across the industry to design and visualize their ideas, to quantify and measure, speed documentation and improve accuracy and efficiency.

Therefore, a sound knowledge of this software will increase individual and organizational productivity and is a must for all construction professionals as well as those aspiring to be construction industry professionals.

This course is ideal for:

- Architects and Building Designers
- Structural Engineers
- General Users



Zoom Area, Zoom In, Zoom Out, Zoom Extents, Position, Wireframe, Shaded, Ghost View, Transparent, Display, Text, Hatching, White, Compare, Measure Distance, View in 3D, Drawing Cache, Drawing Tools

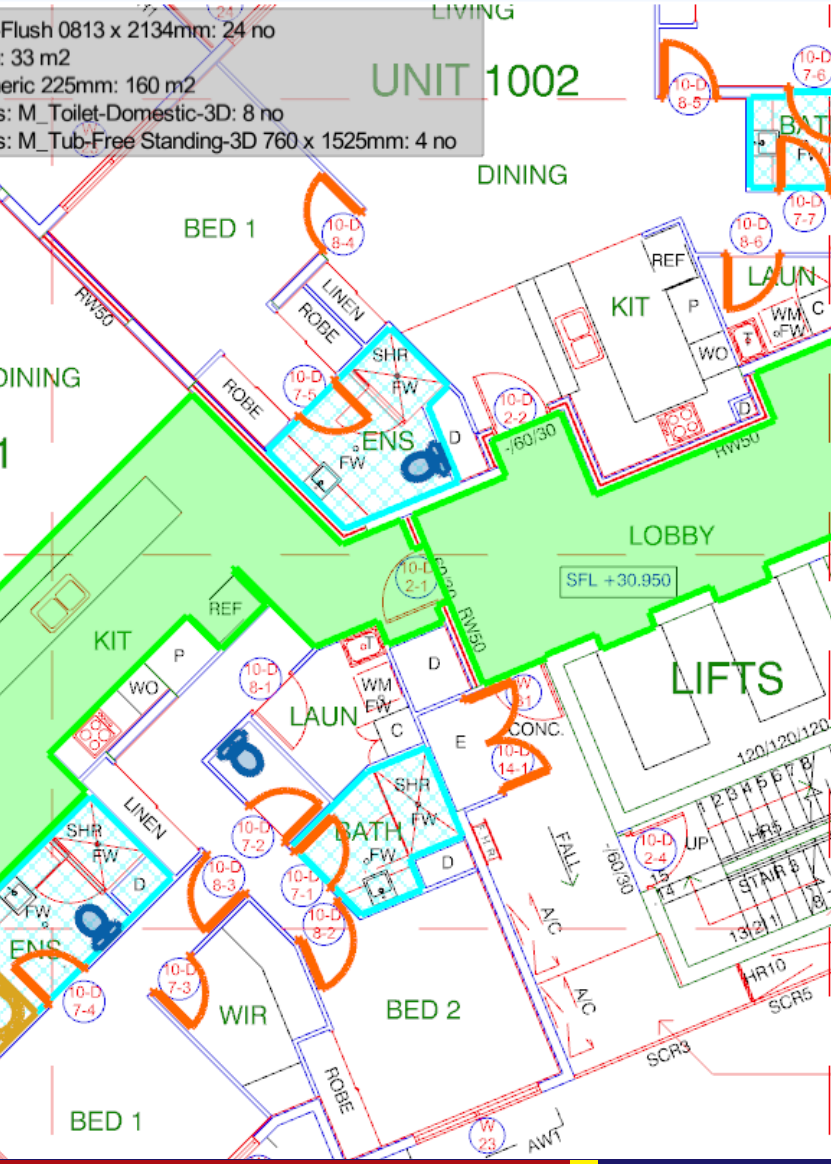

Cost X

Learn to use Cost X to measure, prepare estimates, tenders, Bills of Quantities, Spreadsheet applications. 2D/3D (BIM) Estimating Solution.

CostX by Exactal is a cloud-based and on-premise construction estimating solution designed for construction and property industries. Applications for multiple solutions such as flooring, roofing, landscaping, shop fitting, structural steel, quantity surveyors and masonry are available. Key features include 2D drawings, 3D drawings, reporting, subcontractor comparison and bid management.

CostX helps users measure counts, lengths and areas from scanned documents and computer-aided design (CAD) drawings. With building information modeling (BIM), quantities and costs can be estimated using digital design data. The solution offers functionality for spreadsheet-based workbooks that are linked with drawings and cost database.

CostX offers an auto-revisioning tool that helps users compare drawings and update quantities automatically. Additionally, a subcontractor comparison tool is also available. Users can prepare customized reports that can include bills of quantities and cost plans.

Course Content:

- 2D Takeoff (Measuring and Estimating Cost)
- 3D/BIM Takeoff (Measuring and Estimating Cost)
- Workbooks
- Auto Revisioning
- Sub Contractor Comparison
- Reporting

MS Project

Microsoft Project is a project management software product, developed and sold by Microsoft. It is designed to assist a project manager in developing a plan, assigning resources to tasks, tracking progress, managing the budget, and analyzing workloads.

Microsoft Project provides robust project management tools with the right blend of usability, power, and flexibility, to manage projects more efficiently and effectively. Microsoft Project enables to easily plan projects, effectively manage resources and collaborate with others.

Microsoft Project 2016 has all the functionality and features with some enhancements and new features including more flexible time-lines, better control over resource scheduling.

TIBET provides hands-on, instructor-led activity based classes for Microsoft Project 2016.

Course Content:

Modules:

Project Management Concepts
MS Project version 2016

Project Management Concepts
Project Management knowledge areas:

- Scope Management, Time Management, Cost Management, Quality Management, Procurement Management, Human Resource Management, Communications Management, Risk Management, Integrations Management

MS Project

- Set Project Working Time (Calendars)
- Define activities, sequence & estimate durations
- Critical Path analysis
- Develop a schedule plan & Control, Network Analysis & CPM (critical path method)

- PERT – Program Evaluation Review Technique, PDM – Precedence Diagramming Method
- Preparing of work breakdown structure
- Resource planning & Cost Estimation
- Preparing Resources, allocation of material & work Resources, resource work contours, Labour Histograms and resource leveling
- Defining Project Constraints
- Identify Project risks
- Generating various reports according to the industry needs
- Scheduling multiple projects
- Progress Monitoring
- Earned value analysis

	Accrual	Total Cost	Baseline			
	\$0.00	\$3,622.00	\$1,372.00			
Get permits	\$0.00	\$550.00	\$550.00			
Clean walls	\$0.00	\$80.00	\$80.00			
Project Management Concepts	\$0.00	\$40.00	\$50.00			
Paint walls	\$0.00	\$192.00	\$192.00			
Project Management Concepts	\$0.00	\$0.00	\$0.00			
Remove painting t	\$0.00	\$20.00	\$20.00			
new applian	\$0.00	\$80.00	\$80.00			
Remove floori	\$0.00	\$2,580.00	\$80.00			
Remove floori	\$0.00	\$80.00	\$0.00			
Remove floori	\$0.00	\$340.00	\$320.00	\$20.00		
Remove floori	\$0.00	\$80.00	\$80.00	\$0.00		
Remove floori	\$0.00	\$80.00	\$80.00	\$0.00		
Remove floori	\$0.00	\$180.00	\$160.00	\$20.00		
Remove floori	\$0.00	\$160.00	\$80.00	\$80.00		

Built-In

- Cost
- Entry
- Hyperlink
- Schedule
- Tracking
- Variance
- Work
- Summary
- Usage
- Reset to Default
- Save Fields as a New Table
- More Tables...

Filter: All Activities				
Activity Name	Auto Compute Actuals	Original Duration	Start	Finish
Notice to Proceed	<input checked="" type="checkbox"/>	58.0d	01-Jan-2018	10-Apr-2018
Project Start	<input checked="" type="checkbox"/>	0.0d	01-Jan-2018	
Management	<input type="checkbox"/>	56.0d	03-Jan-2018	10-Apr-2018
Complete	<input checked="" type="checkbox"/>	0.0d		10-Apr-2018
		10.0d	03-Jan-2018	18-Jan-2018
	<input type="checkbox"/>	10.0d	03-Jan-2018	18-Jan-2018
		31.0d	22-Jan-2018	14-Mar-2018
		13.0d	22-Jan-2018	12-Feb-2018
Site	<input type="checkbox"/>	8.0d	22-Jan-2018	01-Feb-2018
Foundation	<input checked="" type="checkbox"/>	9.0d	22-Jan-2018	05-Feb-2018
Conduit	<input type="checkbox"/>	3.0d	05-Feb-2018	07-Feb-2018
able Trench	<input type="checkbox"/>	4.0d	06-Feb-2018	12-Feb-2018*
		20.0d	08-Feb-2018	14-Mar-2018
Steel Structures	<input type="checkbox"/>	8.0d	08-Feb-2018	21-Feb-2018
Equipment	<input type="checkbox"/>	6.0d	13-Feb-2018	21-Feb-2018
Grounding	<input type="checkbox"/>	2.0d	22-Feb-2018	26-Feb-2018
Buses and Jumpers	<input type="checkbox"/>	8.0d	22-Feb-2018	07-Mar-2018
Control Cable	<input type="checkbox"/>	12.0d	22-Feb-2018	14-Mar-2018
		7.0d	05-Feb-2018	14-Feb-2018
Fence	<input type="checkbox"/>	7.0d	05-Feb-2018	14-Feb-2018*
		23.0d	13-Feb-2018	22-Mar-2018
le Equipment	<input type="checkbox"/>	5.0d	15-Mar-2018	22-Mar-2018
ining	<input type="checkbox"/>	2.0d	13-Feb-2018	14-Feb-2018
adway	<input type="checkbox"/>	4.0d	13-Feb-2018	19-Feb-2018
		10.0d	26-Mar-2018	10-Apr-2018
Initial Completion	<input type="checkbox"/>	10.0d	26-Mar-2018	10-Apr-2018

Predecessors	Successors	Relationships	Resources	Steps
Activity	W1040		Mobilize	
Resource ID Name	Auto Compute Actuals	Original Duration	Budgeted Units	Actual Units
LE Cable Splicer	<input checked="" type="checkbox"/>	10.0d	100.0h	0.0h
UND.Groundman	<input checked="" type="checkbox"/>	10.0d	200.0h	0.0h
Heavy Equipment Operator	<input checked="" type="checkbox"/>	10.0d	100.0h	0.0h
MAN.Lineman	<input checked="" type="checkbox"/>	10.0d	200.0h	0.0h

Primavera Project Management

Managing projects of any size with this cloud-based, robust, and easy-to-use solution for globally prioritizing, planning, managing, and executing projects, programs, and portfolios. Learn to Plan, schedule and control large scale programs and individual projects. Selecting the right strategic mix of projects, balance resource capacity, allocating best resources and track progress, monitor and visualize project information, fostering team collaboration, integrating with financial management and human capital management systems.

Course Content

- Organisational breakdown structure
- Enterprise Project Structure
- Calendars – Defining Hourly and daily calendars
- Activity definition, Sequencing & estimation duration
- Effectively using the PDM relationships & scheduling the project
- Defining and assigning active codes, project codes & WBS codes
- Grouping activities & Filtering activities
- Preparing resource information
- Assigning resources to activities
- Estimation project cost
- Analyse resources by using resource profile and resource table
- Resource leveling
- Scheduling Multiple Projects & Preparing a Master Plan
- Preparing S curve
- Tracking project Progress & Highlighting the progress in the Gantt Chart
- Earned value analysis
- Application of Global Change
- Preparing Different types of Tabular & Graphical reports according to industry requirements

SAP2000

SAP 2000 is a powerful tool which can be used for all Structural analysis and design tasks, including day to day problems. This intuitive interface allows to create structural models rapidly and intuitively without long learning curve delays. Complex Models can be generated and meshed with powerful Templates built into the interface. SAP2000 represents the state-of-the-art in three dimensional finite element technologies for structural engineering. SAP2000 provides powerful capabilities for analysis and design of a wide range of structures, including bridges, dams, tanks and buildings.

Who is this for:

Personnel engaged with Structural Engineering

Prerequisites:

Knowledge and understanding of Structural Engineering

Course Content

Basic Finite Element Method
Introduction to the use of SAP2000 graphical interface
Defining Materials / Members / Loads / etc
Basic modeling - 1D / 2D / 3D
Frames Shells / plates and Solids
[You will learn to Model any Structure, apply loading, Analysis for different statistical load combinations, find out members Internal / Nodal Reactions which are required to Design Concrete / Steel / Composite Structure]
• Introduction to SAP design program
Introduction to Finite Element Method
Building components (Joint – Frame – Shell)

Define (Material – Frames / Areas)
Types of loads (dead – live – wind)
Effect of load on building components
1-D Frame
2-D Frame
3-D Frame
Plates
Shells
Solids
Result analysis
Complete Project

Deformed Shape (PAx) - Step 4

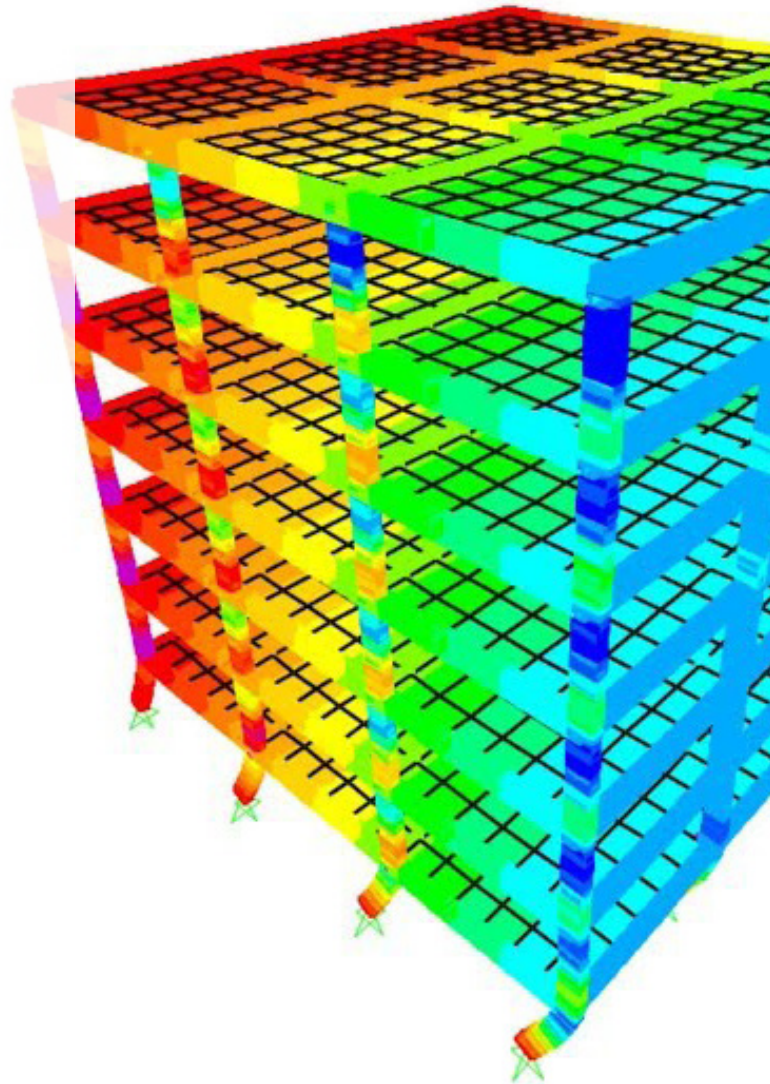

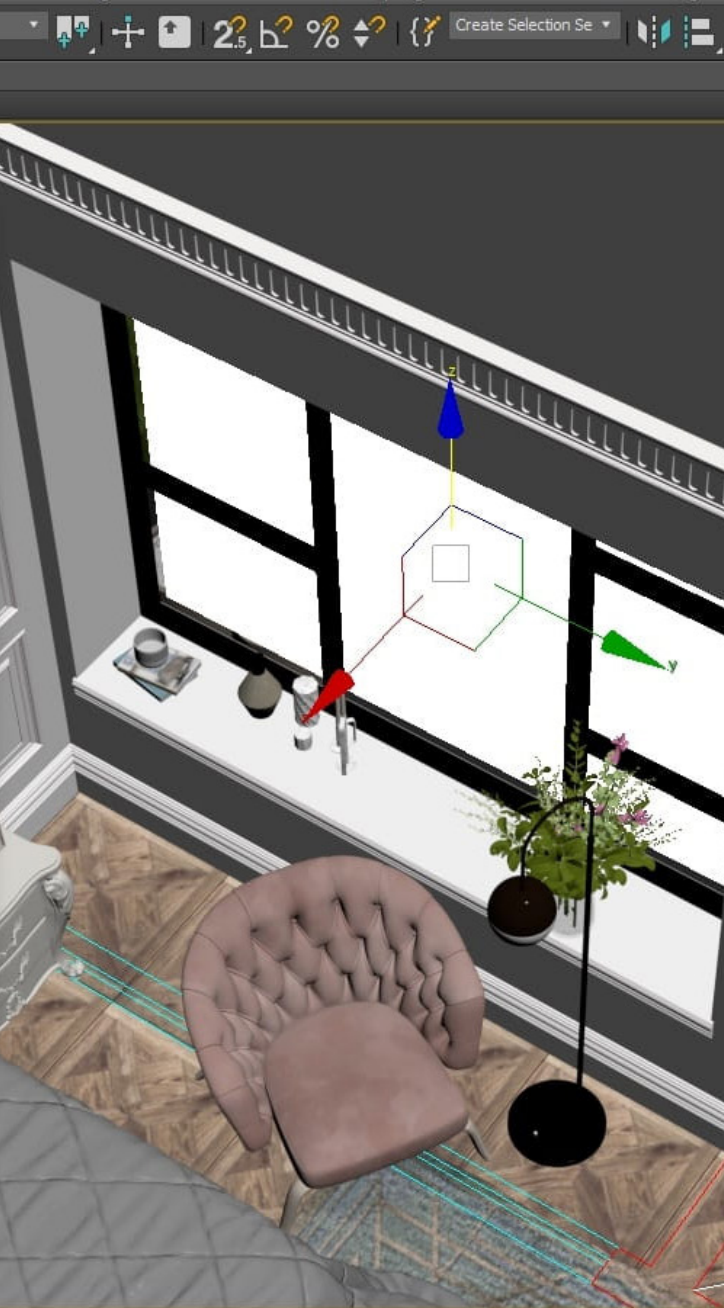

3DS Max

3Ds Max is a diversified software product by Autodesk, It is implemented across the Architectural, Engineering and Construction (AEC) industry to perform Architectural 3D modeling and animations, It can perform 3D Mechanical modeling, 3D Architectural rendering, Exterior & 3D Interior walk-through and 3D Architectural fly-through.

3Ds Max software consists of many rich features that helps the modelers, the renders and the designers to create flawless photo-realistic 3D images as well as 3D animations of any construction element. Combined with special plug-ins like Vray, it can produce next to real renderings of models. It also supports various import features for Autocad files which makes architecture modeling easier. Beside AEC industry, this software has a wide ranging usage in Media, Advertisement and Entertainment industry. 3Ds Max software has excellent capabilities in developing the effective 3D models and It has great compatibility with Microsoft Windows operating system, Some of its versions have compatibility with Apple Mac operating system, 3Ds Max version 2010, 2011, 2012 and 2013 is compatible with Mac operating system.

- Architects, Building Designers, Interior & Landscape Designers and Professionals working in the field and looking to improve their skills.
- Intermediate-level users looking to improve their current demo reels and marketability and work with V Ray.
- Beginners looking to explore new career options in the 3D animation industry.
- Aspiring CG artists who are looking to learn fundamental techniques in modeling, materials, lighting, and advance rendering or those with existing experience who want to improve the quality of their current demo or reel.
- SketchUp, Revit or Lumion users looking to advance their skill set.
- Draftsman who are interested in learning rendering.
- Anyone with a vague interest in 3d.

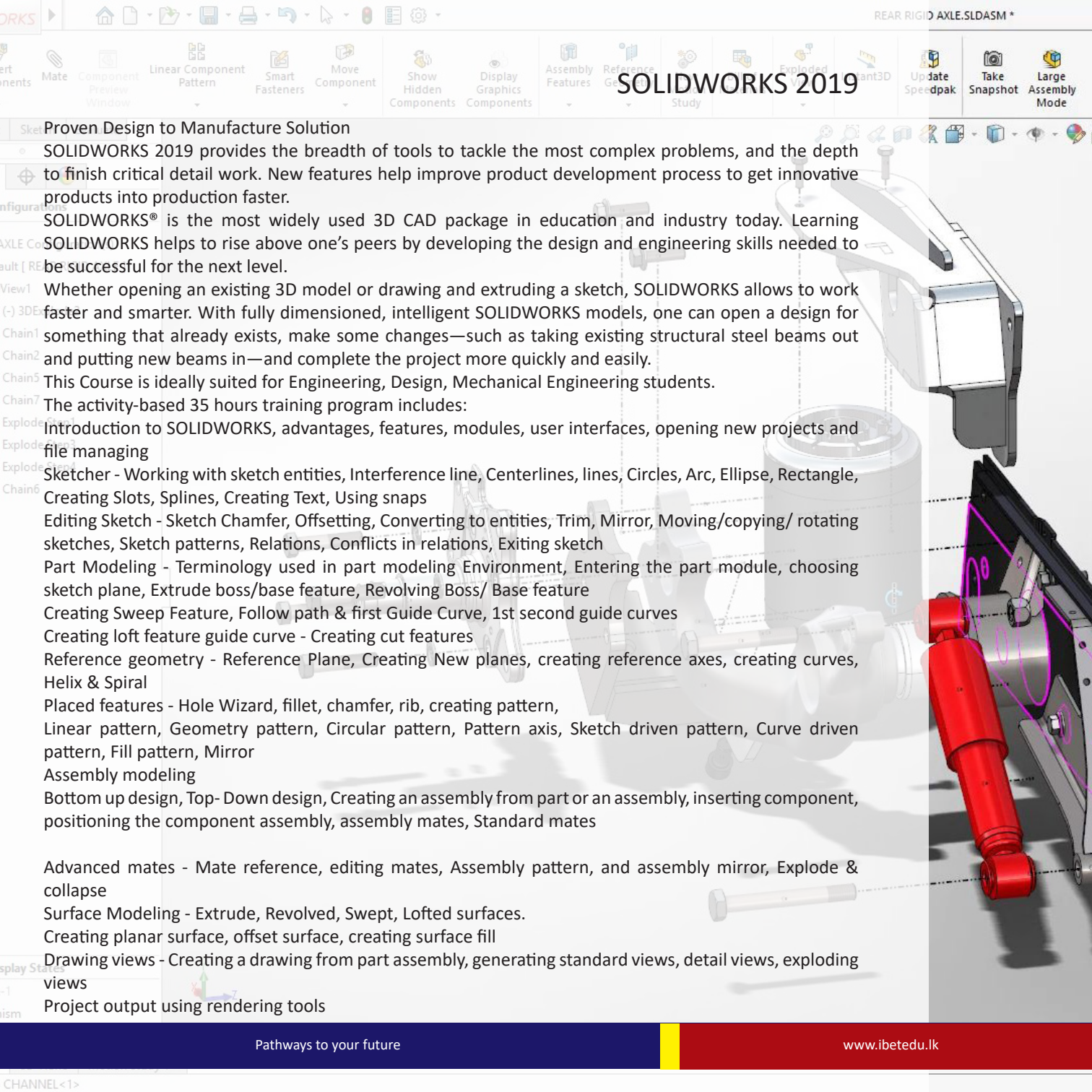

SOLIDWORKS 2019

Proven Design to Manufacture Solution

SOLIDWORKS 2019 provides the breadth of tools to tackle the most complex problems, and the depth to finish critical detail work. New features help improve product development process to get innovative products into production faster.

SOLIDWORKS® is the most widely used 3D CAD package in education and industry today. Learning SOLIDWORKS helps to rise above one's peers by developing the design and engineering skills needed to be successful for the next level.

Whether opening an existing 3D model or drawing and extruding a sketch, SOLIDWORKS allows to work faster and smarter. With fully dimensioned, intelligent SOLIDWORKS models, one can open a design for something that already exists, make some changes—such as taking existing structural steel beams out and putting new beams in—and complete the project more quickly and easily.

This Course is ideally suited for Engineering, Design, Mechanical Engineering students.

The activity-based 35 hours training program includes:

Introduction to SOLIDWORKS, advantages, features, modules, user interfaces, opening new projects and file managing

Sketcher - Working with sketch entities, Interference line, Centerlines, lines, Circles, Arc, Ellipse, Rectangle, Creating Slots, Splines, Creating Text, Using snaps

Editing Sketch - Sketch Chamfer, Offsetting, Converting to entities, Trim, Mirror, Moving/copying/ rotating sketches, Sketch patterns, Relations, Conflicts in relations, Exiting sketch

Part Modeling - Terminology used in part modeling Environment, Entering the part module, choosing sketch plane, Extrude boss/base feature, Revolving Boss/ Base feature

Creating Sweep Feature, Follow path & first Guide Curve, 1st second guide curves

Creating loft feature guide curve - Creating cut features

Reference geometry - Reference Plane, Creating New planes, creating reference axes, creating curves, Helix & Spiral

Placed features - Hole Wizard, fillet, chamfer, rib, creating pattern,

Linear pattern, Geometry pattern, Circular pattern, Pattern axis, Sketch driven pattern, Curve driven pattern, Fill pattern, Mirror

Assembly modeling

Bottom up design, Top- Down design, Creating an assembly from part or an assembly, inserting component, positioning the component assembly, assembly mates, Standard mates

Advanced mates - Mate reference, editing mates, Assembly pattern, and assembly mirror, Explode & collapse

Surface Modeling - Extrude, Revolved, Swept, Lofted surfaces.

Creating planar surface, offset surface, creating surface fill

Drawing views - Creating a drawing from part assembly, generating standard views, detail views, exploding views

Project output using rendering tools



Business School

Courses related to Business Management, Logistic and Supply Chain Management for school leavers and matured learners currently in employment.

UK Level 4 & 5 (HND) Diploma in Business Management

Microsoft Office is an office suite containing MS Word, MS Excel, MS Power point and MS Outlook. This is widely used in personal as well as commercial activities and therefore knowledge of using the MS Office Suite is important before embarking on one's career.

Microsoft Word is a word processor widely used by public all over the world.

Microsoft Excel is a spreadsheet editor.

Microsoft PowerPoint is a presentation program used to create slideshows composed of text, graphics, and other objects, which can be displayed on-screen and shown by the presenter or printed out on transparencies or slides.

Microsoft Outlook is a personal information manager and includes an e-mail client, calendar, task manager and address book.



othm[®]
qualifications ■■■■

UK Level 4 & 5 (HND) in Logistics and Supply Chain Management

The objective of the OTHM Level 4 and 5 Diploma in Logistics and Supply Chain Management is intended to develop learners' understanding of policy, management theory and practice in logistics and supply chain management. It provides learners with an opportunity to engage with the challenges facing professionals and policy makers in their own country. They will provide knowledge that underpins the ability to work as an effective manager in the sector. They combine both theoretical and practical knowledge in the profession and will develop and enhance knowledge and skills in the areas of leading change, effective planning and risk assessment and forecasting. Learners will be able to work in a variety of roles within logistics and supply chain management.

OTHM qualifications at RQF Level 4 and 5 represent practical knowledge, skills, capabilities and competences that are assessed in academic terms as being equivalent to Foundation Degrees, Higher National Diplomas (HND) and Year 2 of a three-year UK Bachelor's degree.

The OTHM Level 4 Diploma in Logistics and Supply Chain Management qualification consists of 6 mandatory units for a combined total of 120 credits, 1200 hours Total Qualification Time (TQT) and 480 Guided Learning Hours (GLH) for the completed qualification. The OTHM Level 5 Diploma consists of 6 mandatory units for a combined total of 120 credits, 1200 hours Total Qualification Time (TQT) and 480 Guided Learning Hours (GLH) for the completed qualification.

Achieving the OTHM Level 5 Diploma in Logistics and Supply Chain Management qualification enables learners to progress into or within employment and/or continue their further study. As this qualification is approved and regulated by Ofqual (Office of the Qualifications and Examinations Regulation), learners are eligible to gain direct entry into Final year of a three-year UK Bachelor's degree.



UK Level 4 & 5 (HND) in Information Technology

The objective of the OTHM Level 4 and 5 Diploma in Information Technology is to provide learners with an excellent foundation for a career in a range of organisations. It designed to ensure that each learner is 'business ready': a confident, independent thinker with a detailed knowledge of Information Technology, and equipped with the skills to adapt rapidly to change.

The qualification is ideal for those who have started, or are planning to move into, a career in private or public sector business. Successful completion of the Level 5 Diploma in Information Technology will provide learners with the opportunity to progress to further study or employment.

OTHM qualifications at RQF Level 4 and 5 represent practical knowledge, skills, capabilities and competences that are assessed in academic terms as being equivalent to Foundation Degrees, Higher National Diploma (HND) and Year 2 of a three-year UK Bachelor's degree.

The OTHM Level 4 Diploma in Information Technology consists of 6 mandatory units for a combined total of 120 credits, 1200 hours Total Qualification Time (TQT) and 480 Guided Learning Hours (GLH) for the completed qualification. The OTHM Level 5 Diploma consists of 6 mandatory units for a combined total of 120 credits, 1200 hours Total Qualification Time (TQT) and 480 Guided Learning Hours (GLH) for the completed qualification.

The Level 5 Diploma in Information Technology qualification has been developed with career progression and professional recognition in mind. Successful completion of this qualification provides learners the opportunity for a wide range of academic progressions including OTHM Level 6 Diploma in Information Technology.





Language School

For children and adults...

IELTS and PTE for migration and
studying overseas...



International English Language Testing System (IELTS)

The International English Language Testing System (IELTS) is the world's most popular and widely accepted English Language Test for study, work and migration. This system assesses all of your skills – reading, writing, listening and speaking. You can choose from two versions – IELTS Academic or IELTS General depending on your requirement. The Campus has a fully equipped Resource Room for the student to use and practice their skills.

Course Content

- Guidance in the IELTS Format
- Training in Listening and understanding variety of accents
- Training in Reading with emphasis on grammar, spelling etc
- Training in writing with emphasis on grammar, spelling, speed and time management
- Training in speaking with emphasis on grammar, pronunciation
- Practice Tests
- Important tips to get the students over the xxxxx

IELTS preparatory course

Course Content

- Essential vocabulary for IELTS
- Grammar related to IELTS
- Fast reading (skimming and scanning) practice
- Listening practice
- Developing competency in speaking and writing

For students with moderately sound English Language skills





PEARSON Test of English

PTE Academic is a computer-based Academic English Language test aimed at non-native English speakers intending to study abroad. It tests reading, listening, speaking and writing.

Questions often test 2 skills together, such as listening and reading or reading and speaking. The whole test is done in a single session, lasting 3 hours and is taken sitting at a computer in a secure test environment. The speaking part of the exam is also done at the computer. Your voice is recorded and sent for marking.

One advantage of this test is that you get your results very quickly. This examination is equal to IELTS as well.

IELTS Academic vs TOEFL vs PTE Academic



General English for Adults

English Language is an important subject to meet the challenges of the modern competitive world. One should not let English Language be a barrier to your success. Our program will assist the student to regain any lost ground, increase productivity and get ahead of others. Modern teaching methods and equipped English Language Laboratory will assist the student to acquire knowledge and excel in life.

Course Content

- Listening and oral communication skills
- Grammar and vocabulary development
- Supervised independent learning
- Social activities
- Understanding tenses (active and passive voice)
- Vocabulary from everyday life
- Reading
- Listening
- Speaking competency development
- Prepositions
- Conjunctions
- Relative clauses





English for Corporates and Businesses

This programme has been developed for those interested in meeting the challenges of the modern competitive world, thus increasing productivity and profitability. The programme will develop the communication and presentation skills of employees. Our program is designed to help you achieve a high level of competence in English for the workplace and covers functional language for business writing, reporting, presentations, negotiations and also fluency in English communication skills. A high level of competence in English for the workplace.

Special customized programmes can be arranged for special groups.

Who is this for?

- For those who have been at work in a company or a business where English Language plays a major role in communication
- For those who have just engaged in a company or a business where English is the main medium in communication
- For those who are aspiring to work in a company or to become a businessman
- For the individuals who feel like they are not at the required competency level
- For those who aspire to become efficient presenters
- For those who have to face with many different nationalities
- For everybody who thinks English is the main medium of world communication
- For those who want to expand their boundaries of employment as well as business opportunities beyond the sky

- For those who want to break the mould of their traditional way of thinking and switch to the new world of work
- By attending this course students are assured that their personality and their smartness are enhanced

Course Content

- Quick grammar and tenses
- A list of professional vocabulary
- Representational skills and competency
- Personality development in communication
- Formal & Informal Writings as communication skills development
- Listening and Reading as Comprehension
- Interaction

Elocution

TIBET provides Elocution to youngsters as an accredited center of the Institute of Western Music and Speech (IWMS). IWMS is the largest and widely recognized institute in this field which is also recognized by the state. Students will be coached and trained in speech and allied subjects to the standards set by this institute enabling the students to sit for various examinations conducted by IWMS in Music, Speech and allied subjects in all grades including Diploma. Their syllabuses compiled by qualified experienced examiners are in keeping with internationally accepted standards.

Who is this for?

- Children from Pre-School up to GCE O/L

Why this course?

- Make your children to speak in English with correct pronunciation
- To enable children to achieve native English speaking levels
- For the children to simulate the intonation as well as annunciation in English
- To enable the children to reach the level of fluency in English to meet the challenges of to-days competitive world
- To enable the students to achieve comprehensive writing competency
- To enable the students to comprehend a text very easily





Computing School

Software training and Graphics designing...



E-Kids

The EdHat E-Kids & Teens programme is designed to build a foundation in IT knowledge among children to assist them with United Kingdom ICT curriculum and proceed on the pathway to a degree level programme in Information Communication Technology.



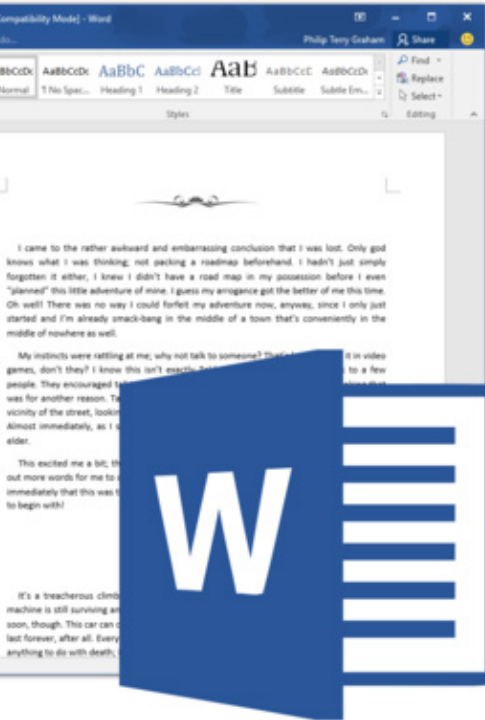

MS Office

Microsoft Office is an office suite containing MS Word, MS Excel, MS Power point and MS Outlook. This is widely used in personal as well as commercial activities and therefore knowledge of using the MS Office Suite is important before embarking on one's career.

Microsoft Word is a word processor widely used by public all over the world.

Microsoft Excel is a spreadsheet editor.

Microsoft PowerPoint is a presentation program used to create slideshows composed of text, graphics, and other objects, which can be displayed on-screen and shown by the presenter or printed out on transparencies or slides.

Microsoft Outlook is a personal information manager and includes an e-mail client, calendar, task manager and address book.

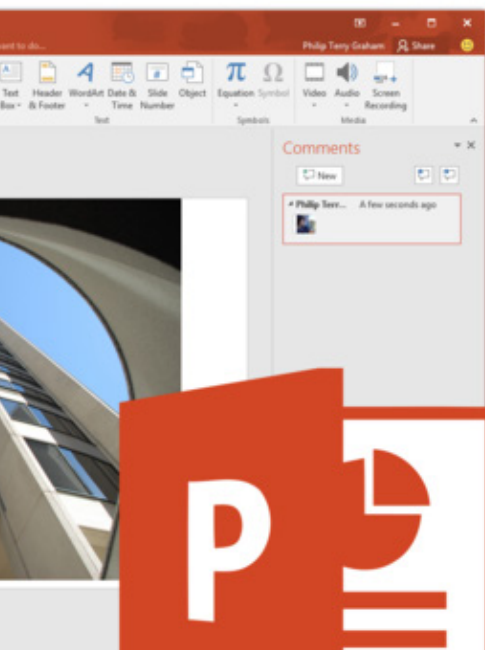
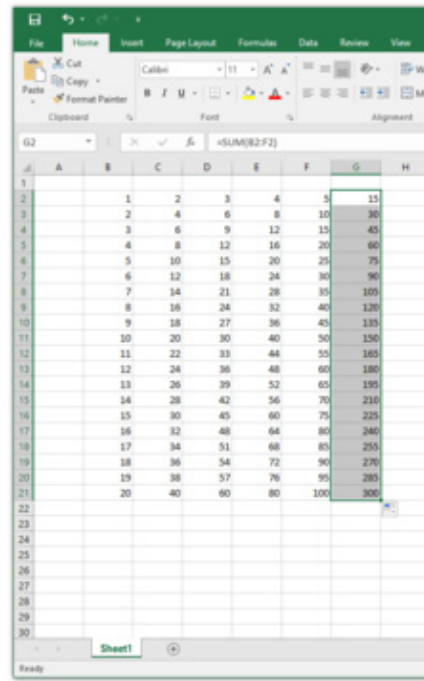

Congratulations on reserving Windows 10

Your free upgrade will be available from July 29th, and now that you've reserved it, you won't miss a minute of Windows 10 helping you do great things.

Graphic Design

This is the art or skill of combining text and pictures in advertisements, magazines, or books. Graphic designers create and combine symbols, images and text to form visual representations of ideas and messages. Graphic designers create visual concepts that inspire, inform, and transform. Use industry-leading tools to build innovative design projects and discover the skills needed to become an in-demand visual thinker and communicator.

- Build a solid foundation in the elements of design: typography, color, and layout.
- Explore the design process to visualize compelling ideas.
- Practice with hands on exercises in InDesign, Illustrator, and Photoshop.





Education is
our passport
to the future,
for tomorrow
belongs to the
people who
prepare for it
today.

Malcom X

“Education is the most powerful weapon which you can use to change the world”... *Nelson Mandela*



Contact us

The Institute of Business, Engineering and Technology Private Limited
First Floor, 199, Horana Road, Wekada, Panadura, Sri Lanka.

Web: www.tibetedu.lk

email: info@tibetedu.lk

Telephone: + 94 38 22 48048/ 48058

Fax: + 94 38 22 48068

